



TOWN OF BRIGUS

P.O. Box 220, Brigus, NL, A0A 1K0

Telephone or Fax: 709-528-4588

Website: www.brigus.net



APPLICATION FOR A DEVELOPMENT

DATE RECEIVED: _____

DATE APPROVED: _____

APPROVED BY: _____

Check all applicable boxes. Provide descriptions and sketches where required. Additional information may be requested at a later date. If the application has to be referred to provincial or federal government departments or agencies, it is the responsibility of the applicant to undertake these referrals. The Town will inform the applicant of any referrals that must be made. Council will approve, refuse, or grant outline planning permission (approval-in-principle) with respect to the proposed development no later than 8 weeks after the date of receipt of this application, unless an extension is agreed upon. **Approval will not be granted if the proposed development does not conform with the Town of Brigus Municipal Plan and Development Regulations. These can be viewed at the Town Clerk's Office. PERMIT FEE TO BE PAID WHEN SUBMITTING APPLICATION.** (There will be two inspections of site. One before work starts and one when foundation is poured.)

Applicant's Name: _____ Civic Number _____ Street Name _____

Phone Number/s _____ Mailing Address _____

PLEASE SUBMIT A PLOT PLAN (SURVEY) AND FLOOR PLAN WITH APPLICATION

" THIS APPLICATION WILL NOT BE ACCEPTED IF APPLICATION FEE IS NOT SUBMITTED WITH IT"

THE FOLLOWING PERMIT FEES HAVE BEEN APPROVED BY COUNCIL:

SHEDS/GARAGE/EXTENSIONS 5 CENTS SQ. FT (Under 400 Sq Ft) \$20.00 - 1 YEAR

NEW CONSTRUCTION 6 CENTS SQ. FT (Under 1000 sq ft) \$60.00 - 2 YEARS

NOTE: SHEDS OR PRIVATE GARAGES OVER 23 FEET HIGH FROM GROUND TO PEAK HAS TO BE ADVERTISED" (NOTE: There will be two inspections of site. One before work starts and one when foundation is poured.)

1. Permission is requested to:

- Construct a Building
- Alter Or Enlarge An Existing Building
- Establish A Mobile Or Prefabricated Home
- Erect A Sign Or Advertisement
- Subdivide Land
- Operate A Gravel Pit Or Quarry
- Clear Land
- Develop Land In Some Other Way

to be used for: (33% of lot permitted for development)

- Square Footage of Lot size _____ Square Footage of Existing Buildings (if applicable) _____
- Single Family Residence Total Square Footage: _____ X 6 cents = \$ _____
- Cabin Or Cottage
- Shed - Height from ground to Peak _____ Length _____ Width _____
- Residential Garage - Height from ground to Peak _____ Length _____ Width _____
- Multi-Unit Residence
- Commercial (Shop, Office, etc)
- Industrial (Sawmill, Commercial Garage, Warehouse, Etc .)
- Agriculture - Forestry - Outdoor Recreation - Other: _____

If the items checked above do not adequately describe the proposed development please provide further details:

2. If the development involves the construction or alteration of a building, please check any boxes that apply:

Foundation: Concrete Wood Block Pillars Other _____

Basement: Full Size Half Crawl Space No Basement Other _____

Siding Type: Narrow Wide Other _____

Siding Material: Vinyl Aluminum Clapboard Other _____

Corners: Narrow Wide Other _____

Windows: Casement Glider Double/Single Hung Awning Solid Other _____

Roof: Peak Cottage Cape Cod A Frame Salt Box Barn
 Hip Other: _____

Number Of Stories: One Two Three Split Level Other: _____

If the site of the proposed development is already being used describe what the land and any buildings on it are being used for. If vacant, generally describe the land
 Residential Commercial Vacant Forest Bog Other _____

MORE INFORMATION IS REQUIRED ON THE BACK OF THIS APPLICATION

4. Does the site front on a road maintained by the Town?

Yes Name Of Road: _____

No Describe how access is to be provided and give the length of any access road to be constructed : _____

5. Please provide the name of the Person or Contractor and Phone Number/s who will be undertaking the proposed development : _____

6. (A) Will the proposed development require a water Supply? Yes No

How will water be supplied?

- Town water supply system
- Private well
- Other: _____

(B) Will the proposed development require a means of Sewage disposal? Yes No

How are sewage services to be provided?

- Town sewage system
- On-site septic tank and disposal field
- Other: _____

NOTE: A \$1,200.00 DEPOSIT IS REQUIRED FOR NEW WATER/SEWER HOOKUP.

NOTE: PRIVATE WATER AND OR SEWER SYSTEM WILL REQUIRE APPROVAL FROM GOVERNMENT SERVICES BEFORE COUNCIL ISSUES A PERMIT. APPROVED DESIGNERS LIST IS AVAILABLE AT THE GOVERNMENT SERVICES OFFICE IN ST. JOHN'S BY CALLING 709-729-3529 OR 709-945-3106. PLEASE PROVIDE THE NAME WHO IS COMPLETING THE DESIGN PLAN: _____

7. What is land within 30m (100 feet) of the site of the proposed development being used for? If it is not being used provide a general description (forest, bog, pond, etc).

North: _____

South: _____

East: _____

West: _____

8. "IMPORTANT" Please submit a Survey with this application or a detailed sketch of the layout of the proposed development, showing property lines, the location of the site with respect to nearby public roads and the position of building/s to be constructed. Provide measurements of the size of the building/s and the distance from the public road. Additional, or more detailed, plans and or architectural drawings may be required. Failure to do so may cause delays in your application.

SKETCH OF LAND AND LOCATION OF BUILDING/S

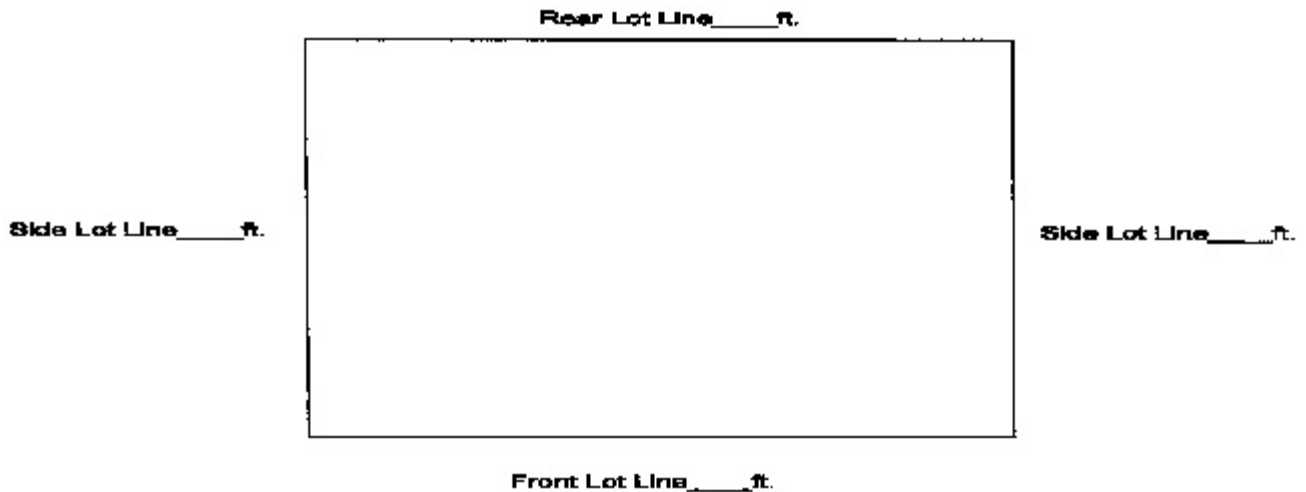

IMPORTANT, PLEASE READ AND SIGN

I am aware that this form is for application purpose only and that anyone who starts any development before receiving written permission to do so from the Town of Brigus may be subject to a fine. Only the kind of development described on this application form is to be undertaken and only at the site indicated. If I wish to use the site for any other purpose, I am aware that another application must first be submitted. If the land to which this application pertains is Crown Land, or land that I am not the sole owner of, I am aware that approval of this application by the Town does not mean I can develop without also obtaining permission from the Department of Environment and Lands or other land owners. I am aware that I am responsible for obtaining any permits from other government departments or for referring this proposal for review to particular government departments or agencies that the Town informs me of; and that I am responsible for providing responses of such referrals to the Town. I am aware that the Town will not grant permission to develop if this proposal does not comply with policies of its Municipal Plan; requirements of its Development Regulations or other requirements of provincial or federal governments. If permission is granted, all applicable federal, provincial and municipal requirements and regulations will be conformed with. No information that could affect a decision to approve or refuse this application has been deliberately withheld or purposely submitted incorrectly by me.

Signature of Applicant: _____

Date: _____